

Adobe Creative Cloud Initial User Login/How to Install Creative Cloud Applications

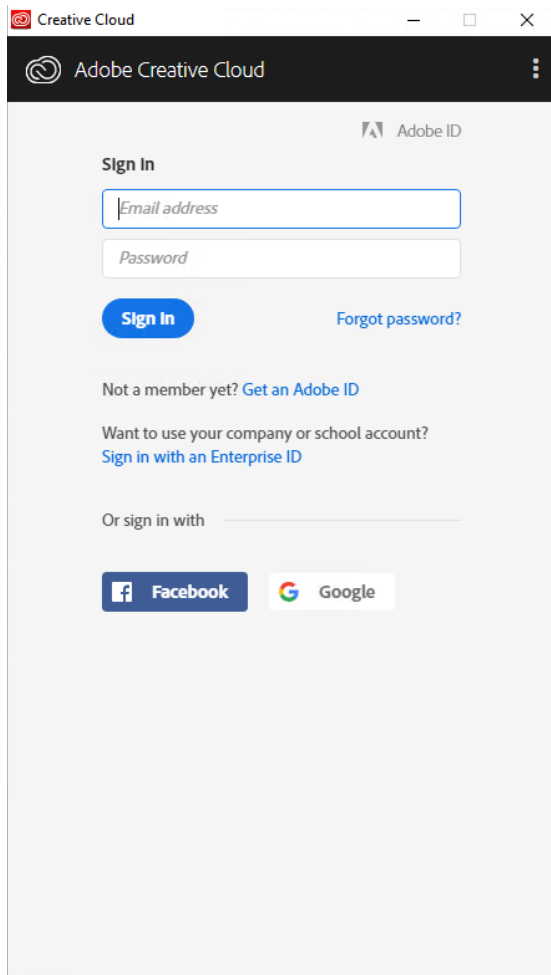

1. Double-Click on the Adobe Creative Cloud desktop shortcut:
2. Click on the [Sign in with an Enterprise ID](#) link:



3. Enter Delgado Email Account, hit Tab key (on keyboard):

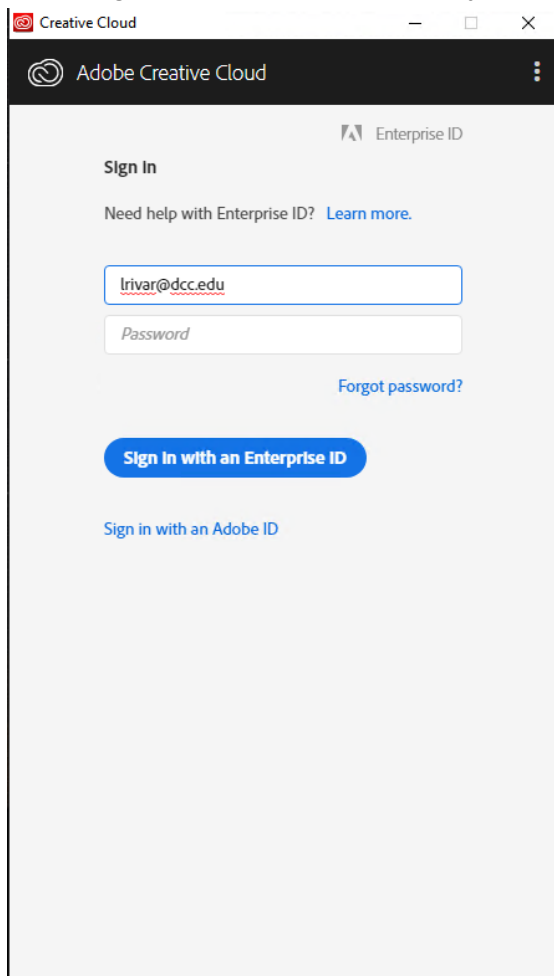

4. Select Enterprise ID:

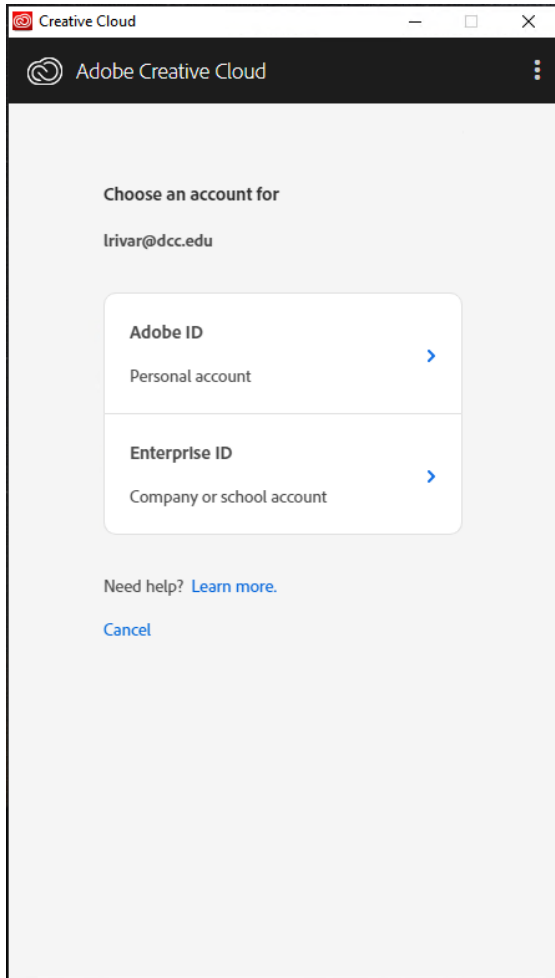

5. Enter your Delgado Email Account Password and select **Sign-In**, then Select **Yes** for Stay signed in?:

Enterprise ID Sign in

Delgado
COMMUNITY COLLEGE

Irivar@dcc.edu

Enter password

.....|

[Forgot my password](#)

[Sign in with another account](#)

Sign in

Having trouble signing in? Please visit our password help page at <https://password.dcc.edu> or call the OIT help desk at 504-671-5500, Monday - Friday from 8:00 a.m. - 4:30 p.m. (CST).

[Terms of use](#) [Privacy & cookies](#) ...

Enterprise ID Sign in

Delgado
COMMUNITY COLLEGE

Irivar@dcc.edu

Stay signed in?

Do this to reduce the number of times you are asked to sign in.

Don't show this again

No **Yes**

Having trouble signing in? Please visit our password help page at <https://password.dcc.edu> or call the OIT help desk at 504-671-5500, Monday - Friday from 8:00 a.m. - 4:30 p.m. (CST).

[Terms of use](#) [Privacy & cookies](#) ...

6. Access to Adobe Creative Cloud Applications has been granted successfully. You may begin installing Adobe applications by selecting the Install option next to the desired Adobe Apps.

